

CHAPTER 5.26 BUFF POINT – RESIDENTIAL

5.26.1 INTRODUCTION

5.26.1.1 Objective of this Chapter

To provide for a schematic road and subdivision layout for the subject lands to ensure orderly development of the unsubdivided residential lots

5.26.1.2 Land to which this Chapter Applies

This Chapter applies to the lands at Buff Point shown in Figure 1 with access to Narambi Road, Elouera Avenue, Vincent Close, Kyong Avenue, Moran Road and Regent Street.

5.26.1.3 Relationship to other Chapters and Policies

This Chapter should be read in conjunction with other relevant Chapters of this Development Control Plan and other Policy Documents of Council, including but not limited to:

- Chapter 2.1 – Dwelling Houses, Secondary Dwellings and Ancillary Development
- Chapter 2.4 – Subdivision
- Council’s Civil Works Specification

5.26.2 IMPLEMENTATION

OBJECTIVE

To provide for the sequential dedication and construction of roads as subdivision occurs

REQUIREMENT

In its determination of applications for the development of the land to which this Chapter applies, Council will require:

- a the dedication and sequential construction of roads in the location shown on Figure 1, and in accordance with Council’s Civil Works Specification.

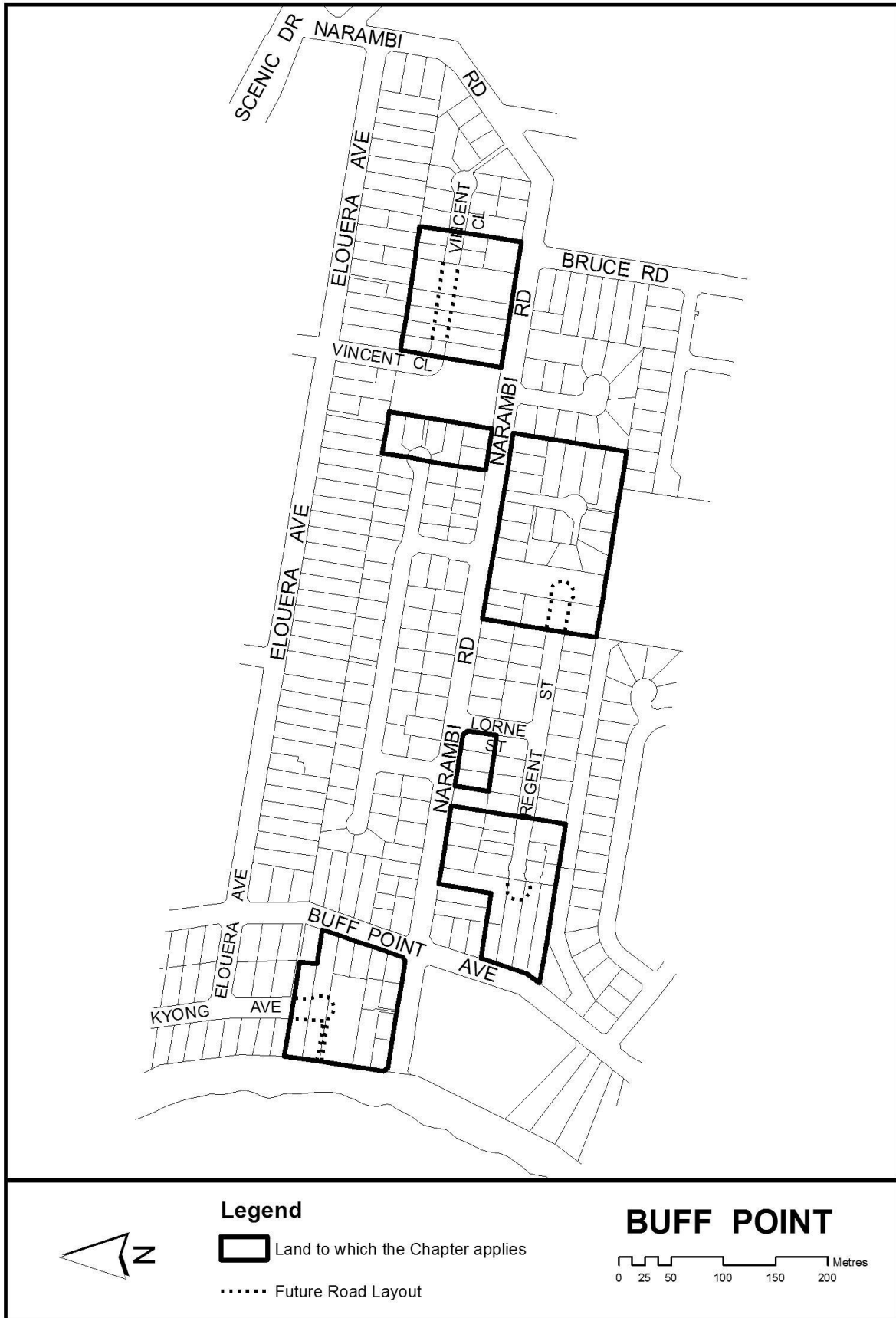

Figure 1 – Land in Buff Point where this chapter applies